



# summer intensive english program for adults

## Information & Registration Package



# Welcome

Welcome to ESLplus Summer Intensive English Program! At ESLplus we provide students with the knowledge and skills needed to be successful in learning the English language. The teachers at ESLplus have been teaching English for several years and have the extensive knowledge of various cultures and English language levels.

This Information and Registration Package summer program packages will provide you with all the information you need about our program. We encourage you to review the package, which includes program regulations, field trips, curriculum, registration form, homestay information, etc. If you have any questions or concerns please contact us by phone or e-mail as indicated below.

Thank you!

Program Director: Irene Lardizabal  
Tel: (905) 896-6949  
Cell: (416) 884-9361  
E-mail: [admin@eslplus.ca](mailto:admin@eslplus.ca)

**Note:**  
**All Information included in this package is subject to change.**

**What's inside this package? (click title to go to corresponding page)**

[Student Handbook](#)

[Program Program Schedule](#)

[Program Curriculum](#)

[Homestay Program](#)

[After-Program Private Tutorials](#)

[Post-Program Programs](#)

[Prices/ Discounts](#)

[Refund Policy](#)

[Registration Form](#)

# summer intensive english program Student Handbook



Welcome to our **ESLplus Summer Intensive English Program!** We look forward to this program with great excitement and hope all of our students will have a rewarding and successful program.

This student handbook is a very important tool for learning at ESLplus. It is a set of information for all our students to be used as reference from time to time.

Both international and local students are warmly received into our Summer Program and we value this opportunity of meeting other cultures. ESLplus recognizes that the learning it provides today needs to prepare all students for life in a global world.

Our aim is to **provide quality language instruction best suited to the needs of our students.** We stress the importance of relevant, practical and communicative curriculum supported by all the important language, cultural and social aspects of education.

At ESLplus, we aim to prepare our students for potential language and social opportunities and to provide international students with the necessary communication skills and fluency in English to succeed in their goals. International students will be fully supported in their learning and well cared for.

## introduction

Established in 2003, ESLplus is a private educational institution primarily for English as a second language (ESL) learners, and later evolved into a service provider for private tutorials for both residents and international students of Canada. ESLplus also offers Homestay Program, teacher training programs through the Academy of Teaching and Training, ESL programs for students, teens and adults, corporate training for companies and educational organizations, and resources/ workshops for ESL teachers. Our staff is experienced, qualified and committed to achieving the learners' goals.

## what does ESLplus offer?

- Language and/or academic excellence
- Quality instruction for all students at all levels
- Up-to-date as well as effective teaching/learning methodologies
- Strong emphasis on life skills
- Individualized, personal mentoring
- Friendly atmosphere

## how do we achieve this?

- A varied and flexible course structure
- Experienced and well qualified teachers familiar with multilevel, multi-aged and multicultural settings
- Caring and involved staff
- A commitment to excellence in all endeavors
- Opportunities and challenges for all our students

## aim of the program

The aim of the program is ***to encourage and support all students to develop their full English communication potential by participating in our Summer Program program.***

**\*Note:** ESLplus has the right to deny applications if it has reached its maximum number of students or if the same culture or language group has reached its limit of number of students. This is to make sure that there is no dominant culture or language group in our program.

## Physical Facilities

Location:

Holy Name of Mary College School, 2241 Mississauga Rd, Mississauga, Ontario

- Large parking space for visitors
- Clean classrooms specially prepared for ESL learning for adults
- Gymnasium
- Library
- Computer Room
- Clean Washrooms

## cultural

ESLplus offers a wide range of Canadian cultural activities through field trips for the students to participate in, like:

- Canada's Wonderland
- Ontario Science Centre
- Toronto Zoo
- Niagara Falls

## two very important rules

**Rule #1: All students need to attend REGULARLY and arrive ON TIME.** It is important to students to arrive on time for program. Regular and punctual attendance is an important life skill for all students. If you know that you will be late or absent, please phone the program director or e-mail [admin@eslplus.ca](mailto:admin@eslplus.ca).

Regular program hours are from 9am to 4pm. Students are not allowed on program property before 8:30 am or after 4:10pm.

**Rule #2: We adopt ENGLISH ONLY policy during our summer program.** Students must speak English at all times during our summer program. This is to encourage our students to practice their English skills even with their classmates who may speak the same native language.

## dress code

Students are encouraged to wear casual, weather-appropriate, comfortable clothes. Note: Female students are to wear modest, proper clothes for language learning. We have children and teens attending our language camps in the same building, so please set an example to our young students by wearing proper attire.

## attendance

All students are expected to **attend regularly** during their registered dates except for medical reasons. If a student is absent, please contact your Program Director as soon as possible stating the reason for his absence. Or e-mail [admin@eslplus.ca](mailto:admin@eslplus.ca). Note: Absences or late days will not be refunded or made up on other days.

## program property

All the rooms assigned to our program, including outdoor surroundings should be kept clean and tidy. Keep off all garden areas and other rooms in the school. Any form of vandalism will not be tolerated and will result to cancellation of the student's any remaining program days. You may be required to pay for damage costs upon full investigation of the case.

## daily routine

Students are to participate actively in our program activities, scheduled trips, and day-to-day learning routines.

## health issues

When students are in the program, they work and interact very closely to each other. If you are ill (e.g. influenza, coughs, colds), please stay at home so others would not be affected. **Sick or late days are not refundable.**

Teachers are not allowed to administer oral medication to students. All other injuries and illnesses will be coursed through emergency 911. (Ambulance costs will be paid by the insurance or by yourself, if required).

Any student who has symptoms of fever during program **should go home.** It is important that students have medical insurance in case of emergencies. It is highly recommended that students have their flu shots before attending our program.

## program staff

- All our staff are TESL/TESOL certified, qualified and experienced to teach English to all levels, all ages, and in all settings.
- Volunteers and assistant teachers underwent criminal record check and were adequately trained to help during the summer program.
- Overall Director of ESLplus Programs: Irene Lardizabal, M Ed TESL. Irene has 23 years of ESL teaching experience in Asia, the Middle East and North America. She is a regular teacher trainer and speaker in TESL conferences across Canada.

## length of study

ESLplus Summer Intensive English Program runs within the summer months, beginning late June. Students may start their course of study at any time during the program period (recommended: start on any Monday – or Tuesday if Monday is a holiday - and end on any Friday). All incoming, new students are assessed by the teachers.

## ESL program

Our ESL classes are small – each group not more than 20, taught by one teacher, assisted by 1-2 teaching volunteers.

## language assessment

The language test has all components of language communication: speaking, listening, reading and writing. Students are evaluated and then placed either in the beginning, intermediate or advanced level.

## homework

Students are encouraged to complete their homework when assigned. Homework is important to follow up on learned topics or skills in the classroom.

## volunteers

Volunteers are an asset in our program. Volunteers provide assistance in classrooms and field trips. We are always grateful to people who offer their help, whether it's once during the week or everyday. If you have some time and interest in volunteering, sign up with the teacher or give us a call or e-mail, and we'll find just the right opportunity for you to get involved.

As per government and ESLplus policies, all volunteers must submit recent criminal record check.

## visiting the program

For the students's safety, all family members or friends of registered students are to call or e-mail us first before visiting. Visiting kin or friends are not allowed to linger anywhere inside the school during program hours.

## food for learning

Good food is fuel for good learning. Breakfast every day will produce the energy needed for active learning and growing. A healthy packed lunch and nutritious snacks are also important parts of supporting learning during the program. Think smart food, not junk food! Students are always welcome to have a bottle of water on their desks. Note: Please inform our staff if you have food or drink allergies for precaution.

# behavioural expectations

All ESLplus staff and students must:

- Respect and comply with all applicable federal, provincial and municipal laws of Canada
- Demonstrate honesty and integrity
- Respect the differences in people, their ideas and opinions
- Treat one another with dignity and respect of all times, and especially when there is a disagreement
- Respect and treat others fairly, regardless of their race, ancestry, place of origin, colour, citizenship, religion, gender, sexual orientation, age or disability
- Respect the rights of others
- Show proper care and regard for the school facilities and the property of others
- Take appropriate measures to help those in need
- Respect persons who are in a position of authority
- Respect the need of others to work in an environment of learning and teaching

Guests at the program are expected to:

- Show proper respect and courtesy to all ESLplus staff and students
- Request for appointment by e-mail or by phone if they wish to speak to the teachers
- Cooperate with and follow ESLplus regulations as stipulated in this handbook

# early returns and dismissal policy

Students may be asked to leave the school premises or expelled from the program for unacceptable behaviour. Any of the following will definitely be considered as reasons for early return, or, after appropriate warnings, expelled from the program (in program and/or homestay settings):

- Lack of or no interest or participation in class activities and homework
- Uttering a threat to inflict serious bodily harm on another person
- Possessing alcohol or illegal drugs
- Being under the influence of alcohol
- Swearing at a teacher or classmate, homestay host or other person in a position of authority (in English or native language)
- Committing an act of vandalism that causes extensive damage to program or homestay house property
- Possessing a weapon, including a firearm
- Using a weapon to cause or to threaten bodily harm to another person

- Committing sexual assault or misconduct
- Committing a robbery
- Irregular attendance or habitual tardiness at program
- Violence or impolite behaviour towards fellow students, teachers, homestay hosts and school staff
- Disregard of program rules
- Intentionally disrupting class routines

If an international student is advised of dismissal from the program, he or she is responsible to book an early flight back to their country. If the student refuses to cooperate, the student will be transferred to police. **Absolutely no refunds in this situation.**

## things to bring

### Recommended:

- swimwear, goggles, towel for swimming (some field trips have swimming facilities)
- Comfortable shoes for program, slippers for home use (for homestay or residence students)
- Personal toiletries (for homestay students)
- Casual summer clothes and footwear (Canadians typically wear simple practical clothes during summer, e.g. shorts, jeans, t-shirts, flip flops, sandals, etc.)
- Backpack or bag for program study materials
- Pens, notebook, etc
- Dictionary (book or digital) – English and native language
- Photocopy of student's passport (for international students only) or photo ID (for local students)

### Optional:

- Hat or cap, sunglasses for outdoor trips
- Sunscreen, lip balm, mosquito repellent
- Rainwear – thin raincoat or foldable umbrella
- Camera, binoculars – for field trips
- Pocket money
- Family pictures for conversation topics

**Please do NOT bring:**

- Illegal drugs, alcohol, firearms, knives, any sort of weapon, gambling paraphernalia, political promotional items
- iPods, walkmans, disc mans, radios, cell phones, Blackberrys, pagers, handheld electronic games, DS, laptop, etc. (Not allowed in classroom during study hours, but permitted during breaks, outside the classroom and during field trips. These will be confiscated by the teacher if used in the classroom, to be claimed after 2 days. ESLplus is NOT responsible for loss or damage of these items.

# about trips and outdoor activities

## Conditions:

1. The students understand that the field trips may take place away from program facility; may involve transportation by school bus, private vehicle, common carrier or other mode of transportation; and may involve activities beyond the scope of traditional program activities conducted on program facility.
2. The students acknowledge that their participation in these field trips and outdoor activities potentially involve risks and obligations that are impossible to predict, but may include the risk of loss or damage to personal property and the risk of sickness, personal injury or death.
3. The students understand that ESLplus does not purchase, or have, any medical, dental, or hospitalization insurance to cover injuries to or loss of life of students or to indemnify students for expenses in connection therewith, and that such insurance, if desired, must be purchased by the students.

## other important reminders students:

- The students give ESLplus their permission to use for promotional purposes any photographs or movies taken in the course of their participation in the summer program program.
- The students agree to release, waive, and discharge, ESLplus and/or their directors, staff and agents from all liability to the registered student, the student's personal representative, assigns, heirs, and next of kin for any medical loss, damage, injury, or even death caused during the summer program.
- The students understand that they will be subject to the laws of Canada. The students acknowledge and understand that should they fall into legal problems related to the summer program; the students will attend to the matter personally with their own personal funds.

<i>Monday</i>	<i>Tuesday</i>	<i>Wednesday</i>	<i>Thursday</i>	<i>Friday</i>
<b>July 2</b> <b>CANADA DAY</b> <b>No Classes!</b>	<b>July 3</b> <b>Program Week 1</b>	<b>July 4</b> <b>Field Trip</b> <b>Niagara Falls</b>	<b>July 5</b>	<b>July 6</b>
<b>July 9</b> <b>Program Week 2</b>	<b>July 10</b>	<b>July 11</b> <b>Field Trip</b> <b>Canada's Wonderland</b>	<b>July 12</b>	<b>July 13</b>
<b>July 16</b> <b>Program Week 3</b>	<b>July 17</b>	<b>July 18</b> <b>Field Trip</b> <b>Ontario Science Centre</b>	<b>July 19</b>	<b>July 20</b>
<b>July 23</b> <b>Program Week 4</b>	<b>July 24</b>	<b>July 25</b> <b>Field Trip</b> <b>CN Tower &amp; Eaton Centre</b>	<b>July 26</b>	<b>July 27</b>

*\*ESLplus reserves the right to change field trip spots/dates depending on availability of the place, weather conditions, etc.*

<i>Monday</i>	<i>Tuesday</i>	<i>Wednesday</i>	<i>Thursday</i>	<i>Friday</i>
<b>July 30</b> Program Week 5	<b>July 31</b>	<b>August 1</b> Field Trip Toronto Zoo	<b>August 2</b>	<b>August 3</b>
<b>August 6</b> No Classes Civic Holiday	<b>August 7</b> Program Week 6	<b>August 8</b> Field Trip Bronte Park	<b>August 9</b>	<b>August 10</b>
<b>August 13</b> Program Week 7	<b>August 14</b>	<b>August 15</b> Field Trip Mandarin Restaurant & Bowling	<b>August 16</b>	<b>August 17</b>
<b>August 20</b> Program Week 8	<b>August 21</b>	<b>August 22</b> Field Trip Playdium & Pizza	<b>August 23</b>	<b>August 24</b>

*\*ESLplus reserves the right to change field trip spots/dates depending on availability of the place, weather conditions, etc.*



## class schedule

<i>Time</i>	<i>Monday</i>	<i>Tuesday</i>	<i>Wednesday</i>	<i>Thursday</i>	<i>Friday</i>
<b>9:00- 9:15</b>	Welcome new Students	Check Homework	Review Field Trip Procedures	Check Homework	Review and answer questions students may have about test
<b>9:15- 10:30</b>	Conversation Practise	Conversation Practise	Leave for field trip	Conversation Practise	Weekly Test
<b>10:30-10:45</b>	Vocabulary & Idioms	Vocabulary & Idioms		Vocabulary & Idioms	Weekly Test
<b>10:45-11:30</b>	Reading Task	Reading Task		Reading Task	Conversation Practise
<b>11:30-12:15</b>	Computer Research	Computer Research		Computer Research	Group Outing
<b>12:15-12:45</b>	Grammar & Punctuation	Grammar & Punctuation		Grammar & Punctuation	
<b>12:45-1:00</b>	Journal Writing	Journal Writing	Return between 4:00pm-5:00pm	Journal Writing	Return from group outing

**\*ESLplus reserves the right to change or modify this schedule, as deemed by the instructor.**

Subject Theme	Conversation Practice	Reading Task	Grammar & Punctuation	Vocabulary & Idioms	Computer	Free Conversation	Journal Writing
<b>Week 1</b> Canadian Culture	-mannerism -traditions -habits	- Canadian traditions. - Canadian history	-Nouns -Pronouns -Periods, question marks, etc	-Vocabulary based on readings. - Idioms popular in Canada	-Group activity - Canadian history	-student's culture compared to Canadian Culture	-What are you likes and dislikes about Canadian Culture?
<b>Week 2</b> Jobs and Interviews	-Occupations - Interviews - job applications	- tasks for various occupations - job interviews	- Verbs - Verb Tenses - commas & semi-colons	- Vocabulary bases on readings. -Idioms of expressions	- group activity - Jobs available in Canada -Job stats Canada.	- Students discuss about their job. - International job stats	- Explain your job. What do you like and dislike about your job?
<b>Week 3</b> Health & Illnesses	-hospital forms - Types of illnesses -Medical System	- Hospital Conversations. - Doctor/ Patient Conversations	- Adverbs & Adjectives - Capitalization	- Body and medical vocabulary - Medical Idioms	- Group activity - types of illnesses - types of cancers in Canada	- Illnesses around the world - Medical system in Canada and other countries	- Why is medicare important?
<b>Week 4</b> Money & Banking	-Canadian money -Banking - Credit Cards	-History Canadian money -Role-playing - banking forms	-Prepositions - Determiners - clauses	- Banking & money - inappropriate idioms	- group activities - banks in Canada - Listening activities	-The importance of money. - Pros and cons of banking	- How is banking and financing different in your country?
<b>Week 5</b> Shopping & Restaurants	- Restaurant manners -types of shops -store manners	-restaurant conversations - shopping conversations	- Articles -parts of speech	- restaurant - stores & shopping - expressions	-listening activities - group activities	- Students discuss restaurant & shopping experiences in Canada. - Canadian habits	- What has your experience living in can be like? Positive or negative? Explain.
<b>Week 6</b> Media & Society	- Affects of Media - Canadian Society	-types of Media -Society around the world	- Parts of Speech - Syllables	- Media - Society & Culture - Media Idioms	- Listening activities - Group work - Popular events	- What is happening in the news and in society	-Do u think the media has a negative or positive effect on our children?
<b>Week 7</b> Religion & Beliefs	- Religions & beliefs in Canada	- Holidays in Canada	-Direct & Indirect Speech	-Religions - Holidays	- Listening activities - group work - research project	- Celebrations in various countries	- What role do you think peoples beliefs play in their lives?
<b>Week 8</b> Literature & Politics	- Popular Canadian literature - Canadian politics	-Canadian Literature - Canadian political system	- direct & indirect speech	-vocabulary from readings. -Political titles	- listening activities - group work - political news	- popular world literature - politics around the world	- What role does literature play in your life?

# homestay program



## **Details:**

Accommodation is provided to both local and international students through our Homestay Program. We have available Homestay host families in Toronto, Mississauga, Brampton, Oakville, and other GTA areas.

## **Our Homestay Program includes:**

- Meticulous process in selection of homestay host families (visual inspection, criminal record background check, interviews, photos, English proficiency)
- Private bedroom (solo or shared): a comfortable bed (includes linen, blanket and a pillow), a work desk with chair and desk lamp with sufficient lighting, closet and a mirror
- 3 meals
- Laundry, TV, telephone and optional Internet use
- Airport pick-up and drop-off (extra cost)
- Free 30-minute overseas call to your family (phone card)
- Access to public transport
- Open communication between host and your family overseas (e-mail only)
- Homestay fees are to be paid minimum 2 weeks in advance to give the Homestay families the time and funds to prepare for your arrival.

Note: For more details about our Homestay program, e-mail [admin@eslplus.ca](mailto:admin@eslplus.ca) and request for *Homestay Guidelines for Students*.

# residence accommodation

Residence dormitory accommodation will be at the **University of Toronto, Mississauga campus** (5-minute bus ride to our camp location). Address: 3359 Mississauga Road North, Mississauga, Ontario, Canada L5L 1C6.

Opened in 2007 and named after international jazz legend and longtime Mississauga resident, Oscar Peterson. This traditional dorm-style residence includes a 250 seat Coleman Dining Hall.

## Details:

- Air conditioned suites with individual controls
- Single bedroom with hallway access and a shared washroom with the adjoining unit
- Wired Internet access
- Controlled entry for security
- Lounge area with comfortable seating and cable TV
- On Campus laundry facilities
- Meals

## Note:

Students should bring their own towels. However, the dormitory provides bed linens, soap and toilet paper but there are no hairdryers and other toiletries that one usually gets in hotels. If a student forgets his towel, the dormitory will provide towels for a separate charge.

Floor diagram:

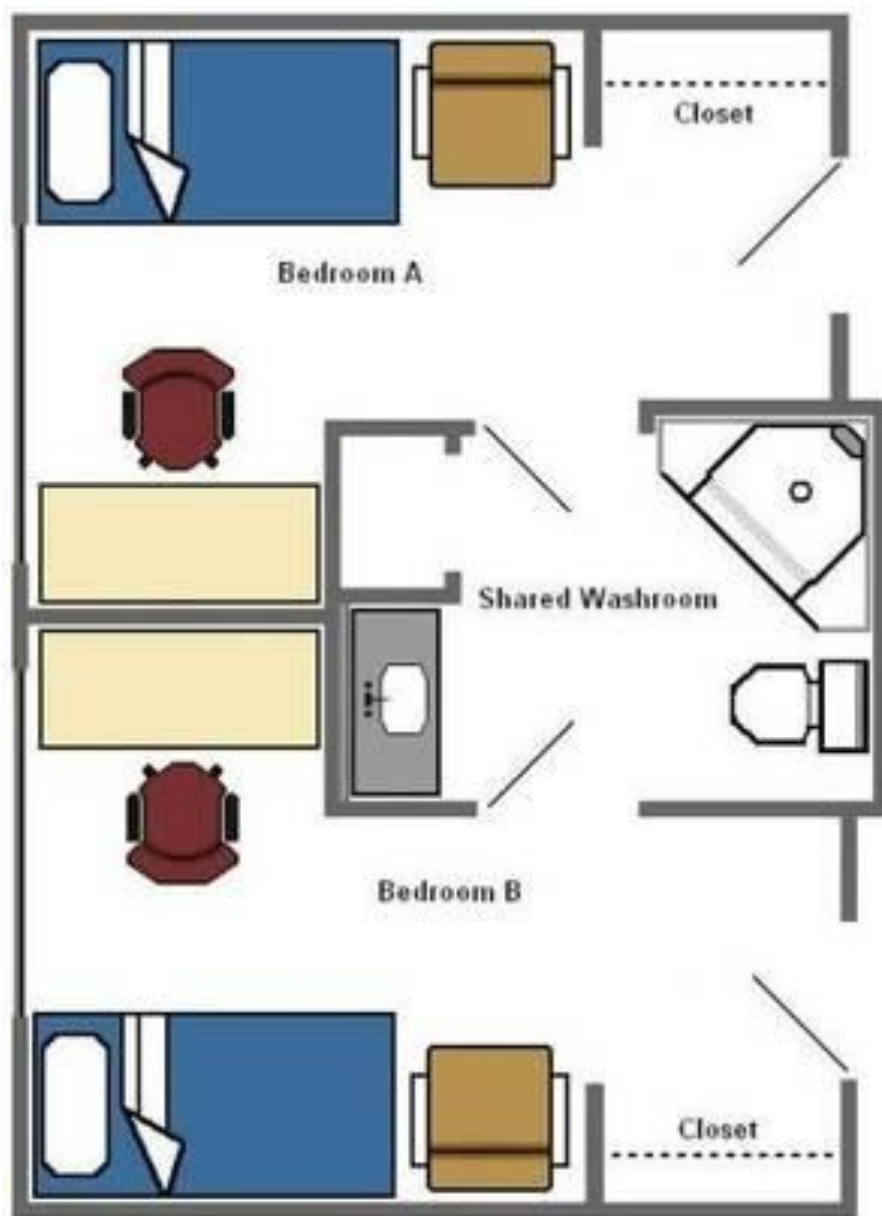

## PRICES

There is no Early Bird Discount, group, or sibling discount for the Adult Program.

*\*All prices in Canadian currency. \*All prices are subject to change*

# of weeks	Fees
per week & new renewals	\$302.40
2 wks	\$593.20
3 wks	\$874.80
4 wks	\$1,154.40
5 weeks	\$1,433.00
6 weeks	\$1,701.60
7 weeks	\$1,971.20
8 weeks	\$2,236.80

\*Public transport - bus, taxi, subway & train available in Mississauga..

## ADD-INS

Options	Price
Insurance (Optional)	\$3 per day including weekends
Aiport pickup only OR Airport dropoff only (one way)	\$115.00
Aiport pickup AND dropoff	\$165.00
One-time, Non-refundable Camp Registration fee <i>(new international students only)</i>	\$80.00
One-time, Non-refundable Camp Registration fee <i>(new local students only)</i>	\$35.00
One-Time, Non-refundable Homestay or Dorm Residence Placement Fee <i>(new students only)</i>	\$165.00
Homestay (\$280 <b>per week</b> includes 3 meals)	\$280.00
Dorm Residence (Single accommodation, \$575 <u>per week</u> , includes meals and daily transport)	\$575.00
Private One-on-One English Tutorial <i>After class or weekends</i>	\$35.00
*Advanced English class (Canadian university level grammar, reading and writing) - Mon, Tue, Thu, Fri, 1:30pm-4pm. \$150 per week	\$150.00

\*Minimum 10 students for the Advanced English class.

\*Weekly program fees include English lessons, materials, 1 full day field trip, and applicable taxes.

\*A *progress report* and a *certificate of participation* are awarded to all our students on their last day at the program.

\*All packages apply to both 4-day and 5-day weeks (July 2<sup>nd</sup> and August 6<sup>th</sup> are holidays).

\*NO REFUNDS within 10 days prior to selected program start date. Insurance is optional. You can choose your own insurance company.

\*Local students must show proof of Canadian status to obtain discounted registration fee (e.g. original citizenship ID, PR card or passport)

\*To pay online using your credit card, please e-mail [paypal@eslplus.ca](mailto:paypal@eslplus.ca) for instructions. 4% charges will apply.

\*To pay by bank wire transfer, please e-mail [admin@eslplus.ca](mailto:admin@eslplus.ca) for our business bank account details. Bank charges will apply.

\*ESLplus reserves the right to change field trip places and dates for various reasons.

\*PLEASE REGISTER FIRST AND READ OUR REFUND POLICY BEFORE PROCEEDING TO PAY THE FEES. THANK YOU.

## refund policy

A request to cancel your registration must be made in **writing** (e-mail, fax or regular mail) addressed to the Camp Director and requires a brief explanation for the withdrawal. If you decide not to attend the program, your tuition is 50% refundable up to 10 business days before the beginning of the program. After this time there is absolutely **no refunds**.

Note: If an international student has been denied visa by the Canadian embassy, the student will get full refund except the non-refundable fees (registration and/or homestay/residence placement fees) and an administration fee of \$90. A cheque payment will be mailed out to the local contact of the student or wired bank-to-bank.

However, if the complaints are about learning and/or teaching English, these will be heard and investigated and appropriate refunds may apply.

### **Note:**

Our program is not a “hunting” ground for potential boyfriends or girlfriends. Our program is an ESL program where we make English learning a priority. If you are simply looking for a place to hang out, or to simply socialize with other single men or women, this program is not for you. If during the program you complain about not meeting students of opposite sex, and you choose to quit the program, there are absolutely NO refunds for such a reason.

## steps to register:

1 Before registering for our program, make sure to **read this information package thoroughly.**

2 **Fill out the registration form.**

Note: Homestay students need to fill out a second form: Homestay Registration Form. Please e-mail [admin@eslplus.ca](mailto:admin@eslplus.ca) and request for the form.

3 Don't forget to check out the Early Bird Discount!

4 **Arrange for the full payment (cash, cheque, bank-to-bank, online credit card payment, etc).** Please note that no booking will be confirmed until the payment has been received.

5 Mail out, scan/e-mail or drop off the following documents as soon as possible:

- **Registration Form**

- Copy of passport for international students (page with photo)
- Copy of citizenship ID, birth certificate or PR card for local students
- Copy of flight details, if requesting for airport pick-up and/or drop-off
- Copy of insurance policy for international students (except if you are using ESLplus recommended insurance company)
- Copy of Canadian health card for local students

Our mailing address: ESLplus Inc., 4 Robert Speck Parkway, Suite 1500, Mississauga, ON L4Z 1S1 Canada

Our e-mail: [admin@eslplus.ca](mailto:admin@eslplus.ca)

6 We will confirm your booking by e-mail and send you an official receipt for the payment. For those who plan to apply for Canadian visit visas, we will scan/e-mail to you the Letter of Acceptance which you will present at the embassy.

7 If you are denied visa, you are required to provide proof (embassy's stamp on the document). We will refund your payment but we retain the following:

- Non-refundable registration fee
- Non-refundable homestay placement fee, if you also applied for homestay.
- Administration fee of \$90 and other incurred expenses if you requested faxes and mailing (speed or regular) from us. Copies of receipts will be provided to you, if any.

For further booking assistance, please do not hesitate to contact us.

## Summer Intensive English Program 2012 REGISTRATION FORM

Please print clearly. Thank you. One form per student.

General Student Information			
Student First Name			
Student Last Name			
Gender (please check ✓)	<input type="checkbox"/> Male <input type="checkbox"/> Female	English name, if any	
Birthdate (mm-dd-yyyy)		Age	
Complete address (country of origin)			
First Language		Other languages	
Allergies?	<input type="checkbox"/> No <input type="checkbox"/> Yes (specify) .....	On medication?	<input type="checkbox"/> No <input type="checkbox"/> Yes (specify) .....
Family e-mail address		Student's e-mail address, if any	
Emergency Phone Numbers			
Program Information			
Need private transport to and from program?	<input type="checkbox"/> No <input type="checkbox"/> Yes (extra costs will apply)	Do you need homestay?	<input type="checkbox"/> No <input type="checkbox"/> Yes (Homestay fees are separate)
Specify start and end program dates	From	to	
Preferred communication from ESLplus	<input type="checkbox"/> By phone, best time to call me .....	Check (✓) how you heard about ESLplus	<input type="checkbox"/> Flyer <input type="checkbox"/> Internet search <input type="checkbox"/> Google <input type="checkbox"/> Family/Friend <input type="checkbox"/> Other (pls specify) .....
If Canadian resident, please write the health card number, including family doctor's name and phone number in the next box			

Fill in the Payment information	<p>1. Check your preferred package number:  <input type="checkbox"/> #1 - day student   <input type="checkbox"/> #2 – homestay + lessons   <input type="checkbox"/> #3 – residence + lessons</p> <p>2. Number of weeks: _____      3. Price: _____ (refer to price list)</p> <p>4. Camp Registration Fee: _____</p> <p>5. Homestay Registration Fee (homestay students only): _____</p> <p>6. Insurance (optional): _____ # of days including weekends x \$3.00 = _____</p> <p>7. Airport pickup/dropoff (optional) = _____</p> <p>8. Private tutorials (optional): _____ # of hours x \$35.00 = _____</p> <p>9. Special Camp (optional): Dates of class(es) &amp; price: _____</p> <p>10. Homestay fees (optional - \$280 per week) = _____</p> <p>11. Residence fees (optional) = _____</p> <p>12. Advanced English Class (optional) = _____</p> <p>ADD #s 3 - 12. GRAND TOTAL: _____</p>
---------------------------------	---

Student's Status in Canada	<input type="checkbox"/> Citizen <input type="checkbox"/> Landed Immigrant <input type="checkbox"/> Refugee <input type="checkbox"/> Visitor <input type="checkbox"/> Student <input type="checkbox"/> Other	Check the student's level of English (Check one)	<input type="checkbox"/> Basic, almost zero <input type="checkbox"/> Beginner – some words, phrases, mostly spoken <input type="checkbox"/> Intermediate – can speak, read and write a little bit <input type="checkbox"/> Upper Intermediate – can speak, read and write well but wants to improve <input type="checkbox"/> Advanced – almost fluent in all skills but needs more work
----------------------------	---	--	---

Are you staying with a family in Canada?	<input type="checkbox"/> No. I need homestay or residence. <input type="checkbox"/> Yes	Contact details of family or friend in Canada	
--	--	---	--

Do you have insurance?	<input type="checkbox"/> Yes. <input type="checkbox"/> No, but I will find my own. <input type="checkbox"/> No. I would like ESLplus to arrange this for me. (\$3 per day)	Payment method preferred	<input type="checkbox"/> Cheque ( <i>payable to ESLplus</i> ) <input type="checkbox"/> Cash ( <i>please pay in person</i> ) <input type="checkbox"/> Traveller's Cheques ( <i>please pay in person</i> ) <input type="checkbox"/> Bank wire transfer <input type="checkbox"/> Western Union <input type="checkbox"/> Money Order <input type="checkbox"/> Credit Card (VISA or Mastercard) – <i>online only</i>
------------------------	--	--------------------------	---

Before you send this form back to ESLplus, please complete the checklist:	<input type="checkbox"/> Completed registration form <input type="checkbox"/> Full Payment including registration fees, optional homestay, etc. <input type="checkbox"/> Passport copy (international students only) <input type="checkbox"/> Copy of citizenship ID or PR card or birth certificate (local students only) <input type="checkbox"/> Copy of insurance (if not using ESLplus insurance)
---	--

<p>I have read and I commit to follow all the stipulated homestay rules/guidelines set by ESLplus. I agree to release, waive, and discharge, ESLplus and/or their directors, staff and agents from all liability to me, the registered student, our personal representative, assigns, heirs, and next of kin for any medical loss, damage, injury, or even death caused during the study period. I give ESLplus permission to use for promotional purposes any photographs or movies taken in the course of my participation in the program. I understand that I will be subject to the laws of Canada. I acknowledge and understand that should I fall into legal problems related to the program, I will attend to the matter personally with my own personal funds.</p>	<p>Student: Please sign below:</p> <hr style="border: 0; border-top: 1px solid black; margin-top: 10px;"/>
--	--

OFFICE USE ONLY			
Date received		Comments	

PLEASE MAIL, SCAN/E-MAIL OR DROP OFF THIS FORM AT:  
 ESLplus Inc., 4 Robert Speck Parkway, Suite 1500, Mississauga, Ontario L4Z 1S1 CANADA  
 E-mail: [admin@eslplus.ca](mailto:admin@eslplus.ca) Note: The student is officially registered upon receipt of this form, other application documents, and full payment.

© 2012, ESLplus Inc